

## FCC Information

This device complies with part 15 of the FCC Rules. Operation is subject to the following two conditions:  
(1) This device may not cause harmful interference, and  
(2) this device must accept any interference received, including interference that may cause undesired operation.

Changes or modifications not expressly approved by the party responsible for compliance could void the user's authority to operate the equipment. In cases where the manual is provided only in a form other than paper, such as on a computer disk or over the Internet, the information required by this section may be included in the manual in that alternative form, provided the user can reasonably be expected to have the capability to access information in that form.

## IC statement

This device complies with Industry Canada licence-exempt RSS standard[s]. Operation is subject to the following two conditions: (1) This device may not cause interference, and (2) This device must accept any interference, including interference that may cause undesired operation of the device.

Le présent appareil est conforme aux CNR d'Industrie Canada applicables aux appareils radio exempts de licence. L'exploitation est autorisée aux deux conditions suivantes: (1) l'appareil ne doit pas produire de brouillage, et (2) l'utilisateur de l'appareil doit accepter tout brouillage radioélectrique subi, même si le brouillage est susceptible d'en compromettre le fonctionnement.

# Setting Up Your Phone

Follow these step-by-step instructions to set up your F1. Power off the phone and remove battery **before** inserting any cards!

## 1 Remove Back Cover

- Remove the back cover by sliding the back cover down with your fingers.

## 2 Insert microSD™ Memory Card

- Power off the phone and remove battery before inserting memory card.

## 3 Insert SIM (Dual SIM Standby)

- Orient SIM card to match diagram on slot.
- SIM 1 supports GSM connections.
- SIM 2 supports GSM connections.

## 4 Insert the Battery

- Align the battery contacts, then insert the battery contact-first.

## 5 Replace Back Cover

- After installing the SIM card, memory card, and battery, align the cover and slide it closed. Make sure you press all around the edge to ensure a secure fit.

## 6 Charge/Sync

- Plug in the microUSB connector to charge the phone or transfer data.

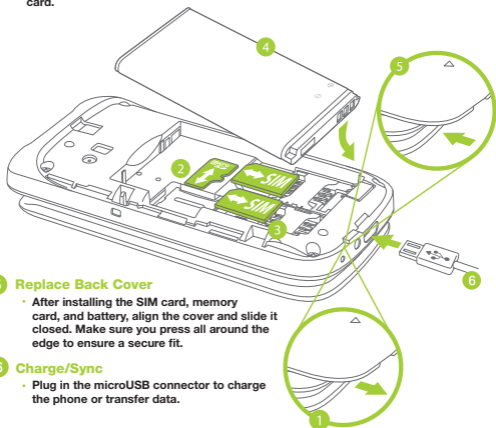

**Warning:** SIM cards are small enough to become a choking hazard, so please keep them away from children. SIM cards are also quite delicate. Please be careful when handling your card.

# F1 General Questions

## Activating MMS

- 1 From the main screen, select MENU → SMS → MMS
- 2 Scroll down and select 6. MESSAGE SETTINGS
- 3 Select 1. SERVER PROFILE.
- 4 Choose the SIM card you want to use to send MMS. [If you only have one SIM card installed, there will only be one choice.]
- 5 On the next screen, select the profile that matches your carrier. [AT&T MMS, T Mobile MMS, etc.]
- 6 Finally, select 1. ACTIVATE PROFILE.

## Customize Shortcut Wheel Actions

- 1 From the main menu, select Menu → Settings → Phone.
- 2 Scroll down and select 3. Shortcuts.
- 3 Select which shortcut to customize and choose from the available actions.

## Expandable Memory

You can add up to 4GB storage space by installing a microSD™ card [sold separately] into the slot underneath the battery. [See **SETTING UP YOUR PHONE** for instructions]

To change the default storage for your camera, open the camera app and select options. Select 4. STORAGE and choose External Card.

# Getting Started With Your

# F1

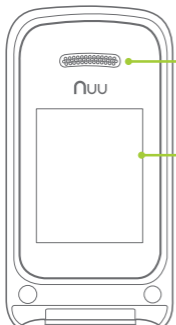

Earpiece  
LCD Screen

## The Keypad

- 1 Menu
- 2 Contacts/Back
- 3 Shortcut wheel
- 4 Menu/Action
- 5 Answer Call
- 6 End Call/Power On/Off
- 7 Hold 1 for Voicemail Call
- 8 Holding # key swaps between GENERAL and SILENT mode



AUX-In/Headset jack



microUSB connector

Microphone

FM Radio Port