

# **USER MANUAL**

## **Iris win1**

# Preface

Thank you for purchasing this cellular phone.

Please follow the instruction in this manual for proper working of cellular phone and avoid malfunction.

Follow all safety warnings to avoid wear & tear or product damage.

Screen displays and illustrations in this user's manual are designed to help you to operate phone.

We continuously strive to improve our products. Therefore, it's in our discretion to revise this user manual or

Withdraw it at any time without notice.

# Welcome

## Exciting Features

Congratulations on becoming a proud owner of iris Win1 mobile phone. You have now joined the millions of satisfied customers spread across the Globe. Your iris Win1 offers you these exciting features and much more:

- Windows 8.1
- 4.0 inch Screen
- Cameras (front VGA and back 5MP)
- 1.2GHz Quad core Processor
- External Memory (Expandable to 32 GB)
- Dual SIM
- Multimedia player
- Proximity Sensor, Ambient Light sensor
- Wi-Fi
- Bluetooth 3.0

# Table of content

Preface.....	2
Welcome.....	3
Table of content.....	4
Important safety precautions.....	6
Appearance and Key Function.....	9
Introduction.....	11
Call Functions.....	14
Personalization.....	19
People.....	20
Messaging.....	24
Connectivity.....	29
Internet Explorer.....	31
Outlook.....	33
Store.....	34
Camera.....	35

Photos.....	36
Music.....	38
FM Radio.....	39
Calendar.....	40
Alarm Clock.....	41
Data Sense.....	43
Storage Sense.....	44
Troubleshooting.....	45
Safety Information and Notices.....	48
Lava warranty certificate.....	54

# Important safety precautions

Failure to comply with the following precautions may be dangerous or illegal.

Please carefully read and observe the terms below:



## **Safe power on**

Do not use your mobile phone where it is forbidden to use or you might cause a disturbance or danger.



## **Safe transportation first**

Please observe all related local laws and regulations. Please drive with both hands.

Transportation security should be considered when driving.



## **Turn off when in hospital**

Please follow related limitations. Please turn off your mobile phone when near a medical instrument.



## **Turn off on an airplane**

Please follow related limitations. Do not use your phone on an airplane.



**Turn off when at a gasoline station**

Do not use your mobile phone at a filling station or around fuels or chemicals.



**Turn off around exposure Area**

Please observe related limitations and do not use your mobile phone around an area where explosion can occur.



**Proper use**

As described in this manual, your mobile phone can be used only in right location.

If possible, please do not touch the antenna area on your phone.



**Use qualified after sale service**

Only a qualified maintainer can install or repair your mobile phone.



**Accessories and batteries**

Only use the authorized accessories and batteries and do not connect to unmatched manufacturers or products.



### **Waterproof**

Your mobile phone is not waterproof. Please keep it away from water.



### **Connect to other devices**

Please read the user manual of the device to get more detailed security instructions before connecting to other devices and do not connect to an unmatched product.

### **Authorized connection**

Please read the user manual of the device to get more detailed security instructions before connecting to other devices and do not connect to an unauthorized connection.



# Appearance and Key Function

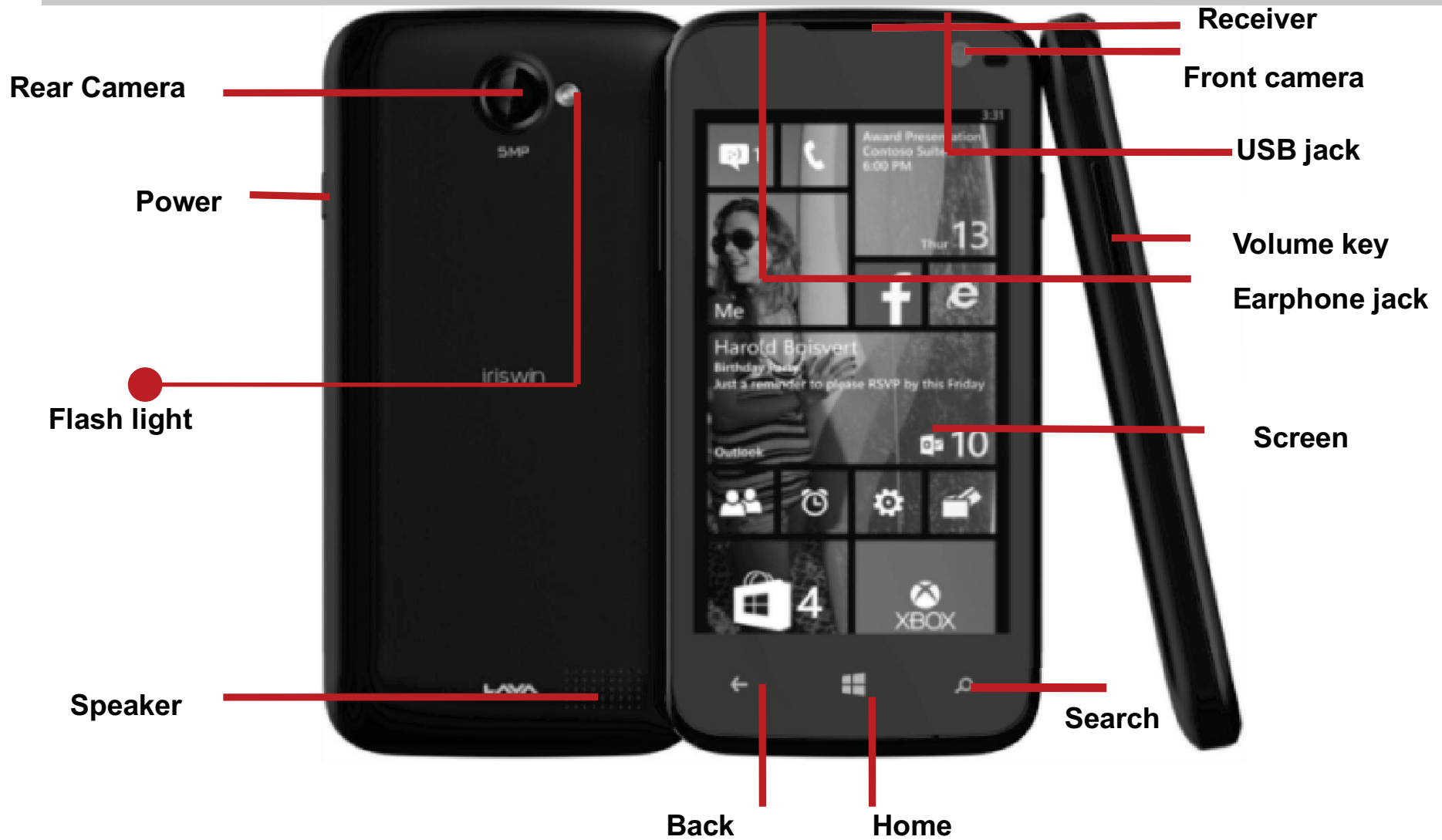

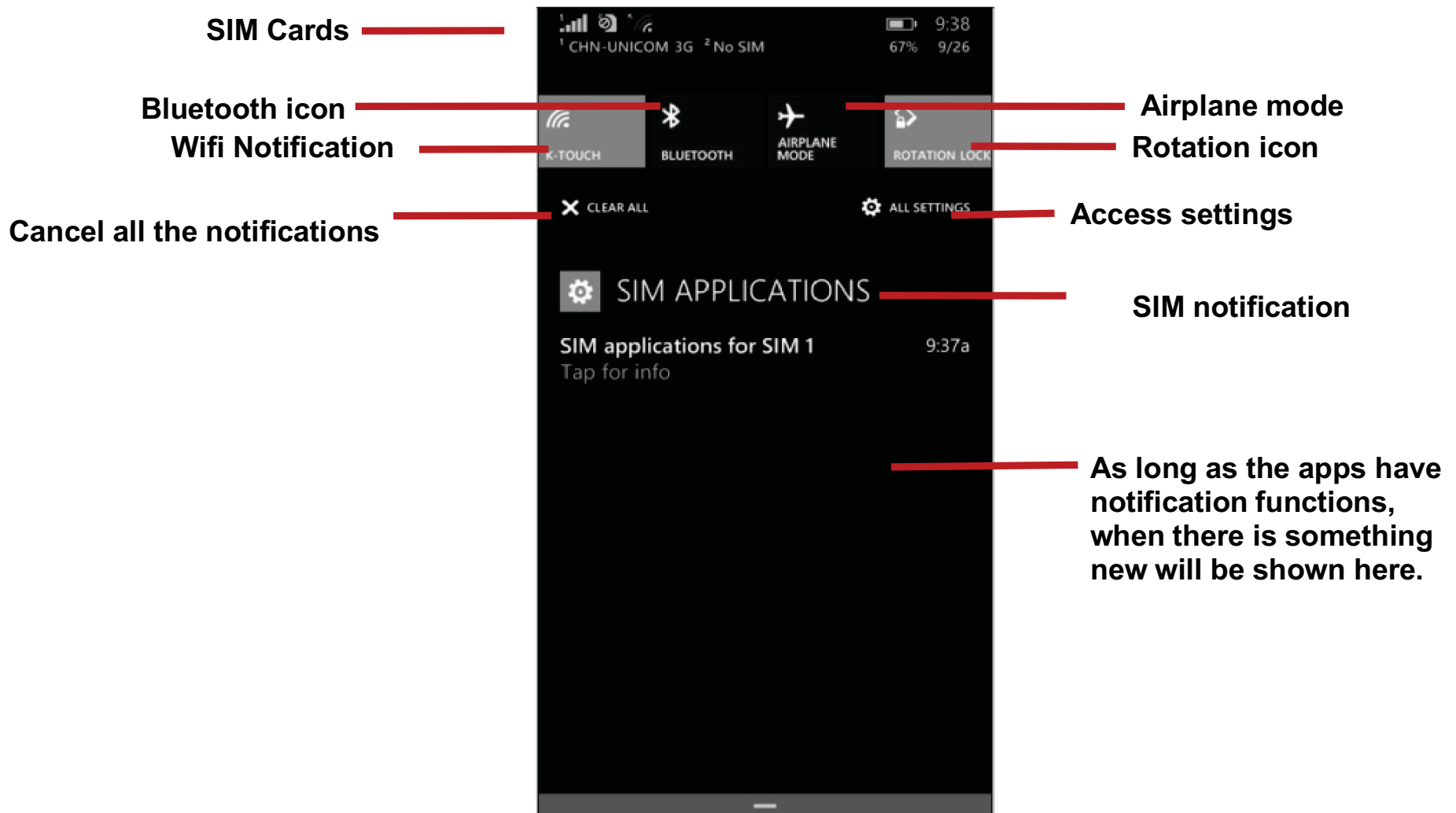

# Introduction

## Installation of the SIM Card

**Warning:** Please keep the SIM card out of the reach of children. The SIM card and its contact are easily damaged due to scratching or bending. Please use caution when carrying, installing or taking out the SIM card. **NB:** Please contact your cellular phone service provider directly to obtain your SIM card.

### To insert SIM cards:

1. Remove the rear cover. Remove the battery, Insert the SIM cards.
2. Insert the SD card. (If any, For additional storage capacity)

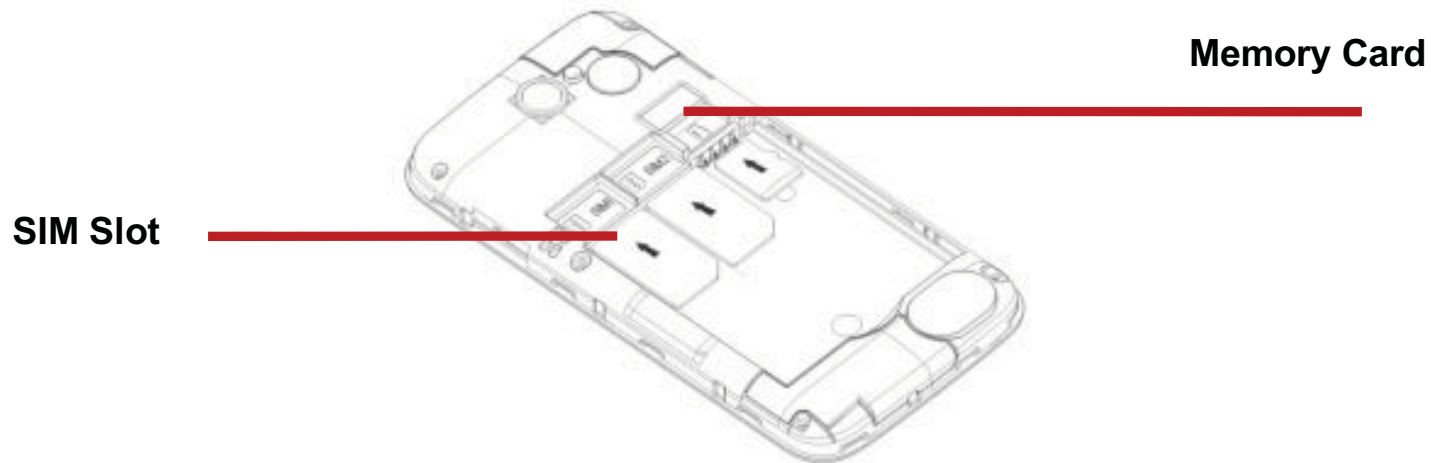

3. Insert the battery, Put rear cover and power on phone.

## **Power On and Off**

**On** - Please ensure the SIM card has been properly inserted into the phone. Long press the Power key to switch on the phone

**Off** - In standby mode, long press on Power key until an options menu appears. Slide the screen down to completely power off the phone.

## **Lock Screen**

You may set a password to the lock screen setting as security measure for the phone. For further information regarding password locks, follow the following steps.

Go to **Settings>Lock screen>Turn ON Password** option.

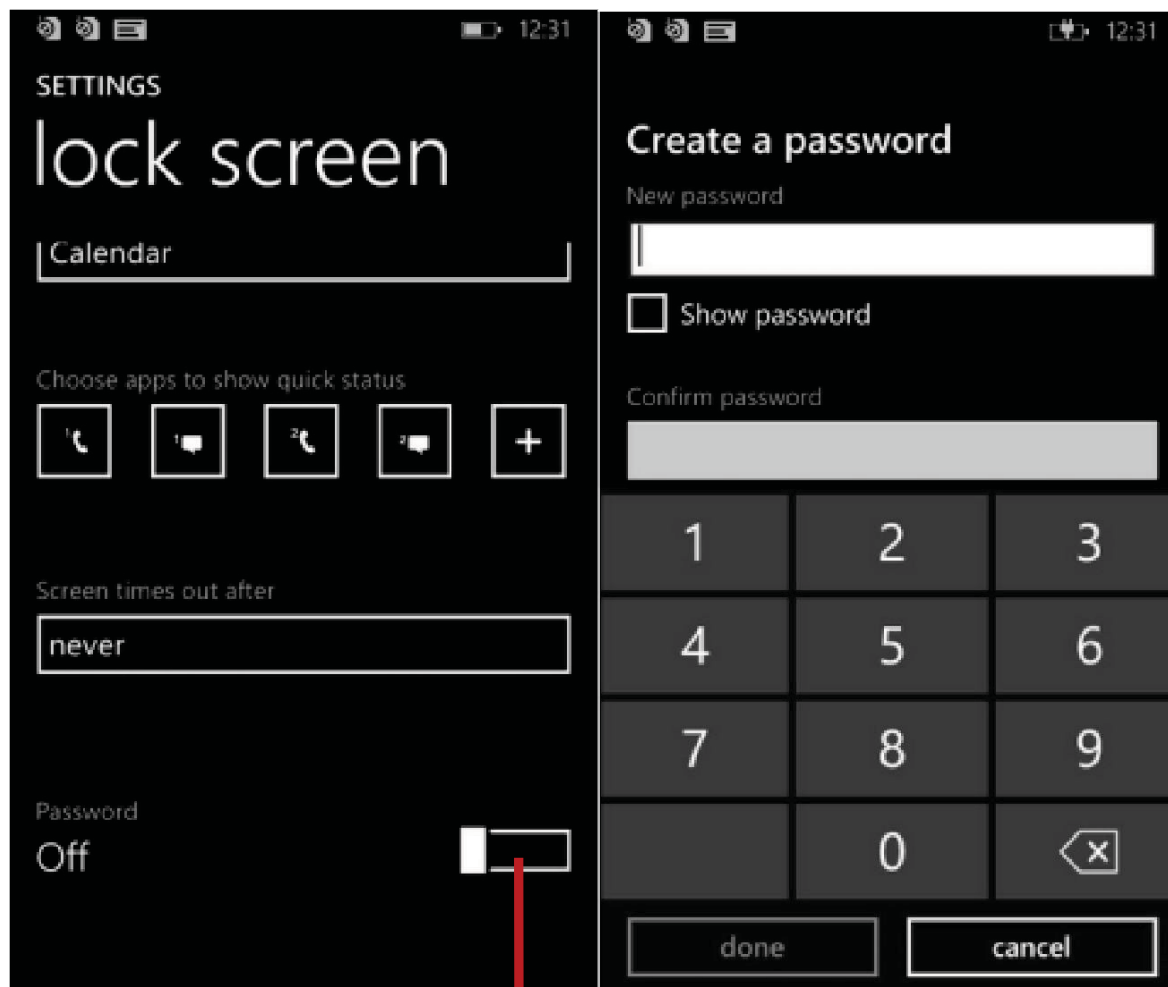

**Turn ON password.**

# Call Functions

## Making a Call

Note: You can make a call only when the network is available.

At the dial keyboard, enter the phone number and then click the dial key. If dialing an extension, you may click the dial pad icon in the bottom of the screen to open the interface and enter the number of the extension. You may also press and hold the 0 key to add a (+) sign when adding an international dialing prefix.

During a call, press the Volume Keys up / down to increase or decrease the volume.

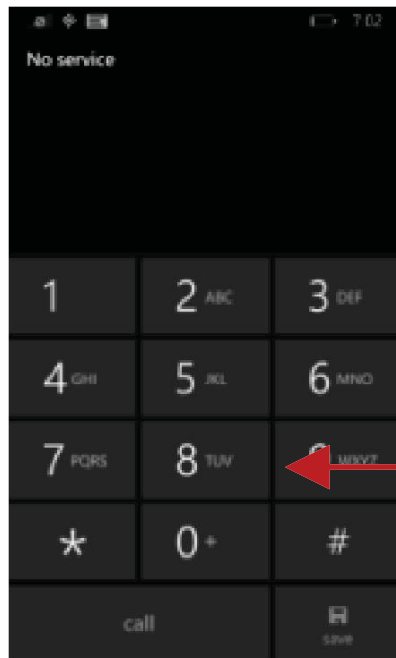

Dial keyboard

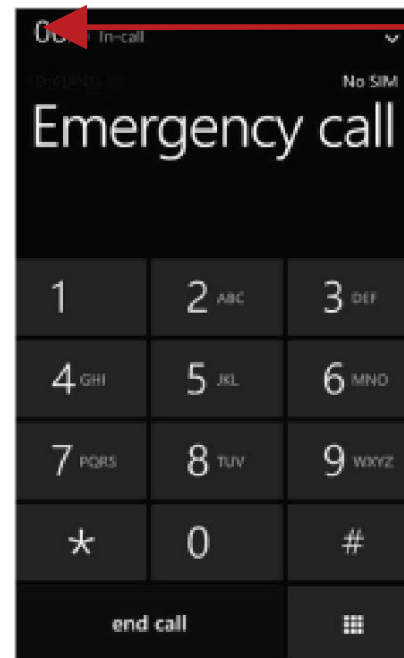

Volume level

## Call Logs

Click the “Phone” application; you can enter into call logs panel.

In every called and received calls will be saved in the phones call log and there are five options at the bottom of the call log panel.

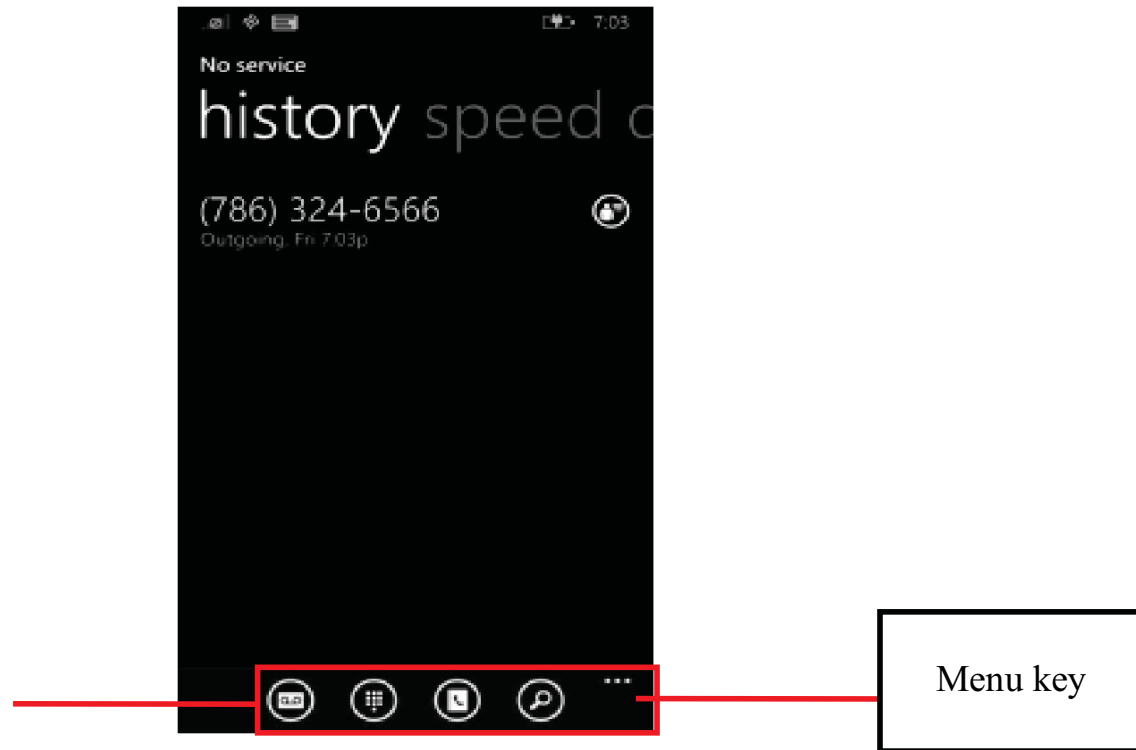

You can use those options to access phone book and dialog panel directly. To clear the call logs, press the menu key and select delete all. You may remove one or multiple numbers. And you can access the following options by clicking the numbers appear on the panel.

## Use in-call options

1. During a call, more than one in-call option can be used at a time.
2. To turn off an in-call option that's turned on, tap the button for the option.





3. To swap or answer a second call, tap the hold button.
4. To merge a call or make a conference call, tap the add call button.
5. To reject or hang up a call, tap the end call button.

## **Signing In**

---

Sign in with a Microsoft account to download apps, back up contacts and more. You can sign in when you set up your phone or you can sign in at any time afterwards.

### **To sign in after you've already set up your phone**

1. In the App list, click Settings, and then click Email + accounts.
2. Click Add an account > Microsoft account.
3. If you already have a Microsoft account, click Sign in. If you don't have a Microsoft account yet, click Create one.
4. Follow the instructions to sign in or create your account.

Please take the following screen shots for your reference.

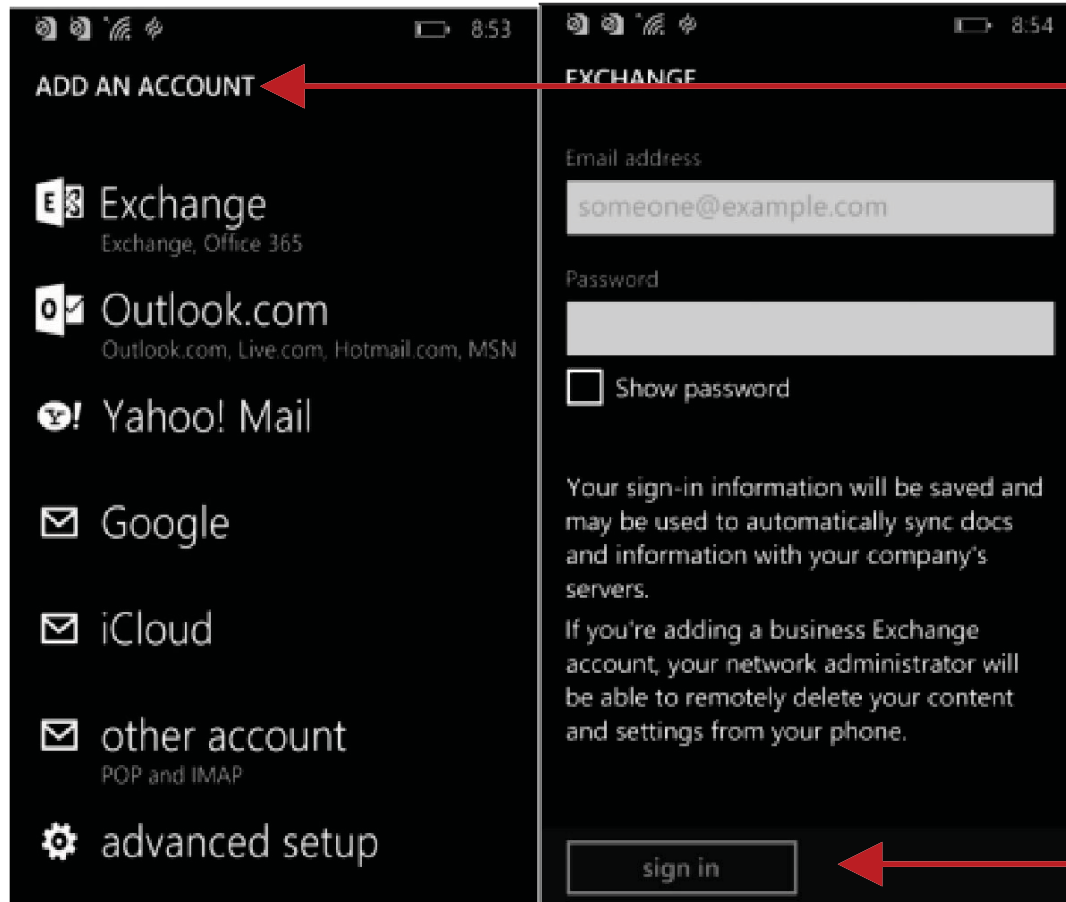

**Add an account  
after clicking  
email**

**Sign in**

# Personalization

On Windows Phone, Start is your home base: you can keep all of your important things just where you need it, perform a task with a click or two, and then press the Start button to zoom right back to the Start screen. You can fill the Start screen with links, contacts, maps and apps, or just a few basics. With Live Tiles, you get notifications and updates in real time, so you don't even have to open an app to see relevant info.

## **Move things around**

---

The phone starts off with preset tiles, but you have the option to customize it your way: when you move Tiles around, you're free to leave gaps between them, have only one Tile in a row or fill up every available space. You can also adjust Tile sizes so you can pack a lot of apps into a small space or enjoy an expanded Live Tile. All Tiles can be shrunk and many can be expanded to span the width of the Start screen.

## **Pinning Apps to Start**

### **To pin an app**

In the App list, click and hold the app you want to pin, and then click Pin to start.

### **To pin a contact**

On Start, click People and press and hold the contact you wish to pin.

## **Add some color**

---

Your phone comes with 20 colors you can use for your Tiles and the accents around the phone.

Your theme color will show up not only on Start and your App list, but also in links, Messaging and other places. You can also choose between a black or white background. On phones, the dark background uses less battery, while the light background has higher contrasts consume more power.

**Tip:** Some colors look little different against the dark background than compare to light background, so if you switch between them, try revisiting different theme colors.

## **Finding your Apps**

---

1. On Start, swipe over to the App list.
2. Click Search to find a specific app, or click a letter to jump to that section.

**Note:** To find your games, go to the App list, and then click Games.

## **People**

**Enter:** Click on the applications menu and select contacts.

- The default display is the phone contacts and SIM card contacts until the phone is synchronized.
- The contacts are displayed in alphabetical order by default.

**Contacts** – Click a name to call text, chat, and email or see social updates. To make the list more manageable, set filters – just click Showing at the top of the list. You'll always be able to find filtered contacts by using a quick search.

**What's new** – Here you can see all of your contacts' latest updates, pulled together from social networks, including Facebook, Twitter and LinkedIn preparing you for an avalanche of posts, tweets, and pictures. Plus, you can configure what information you choose to see.

**Rooms and Groups** – Get to your Rooms and Groups and create new ones from here. Click into a room to start a

chat or view the calendar, notes or photo album or open up a group to see what's new with the members or send them a quick group email or text.

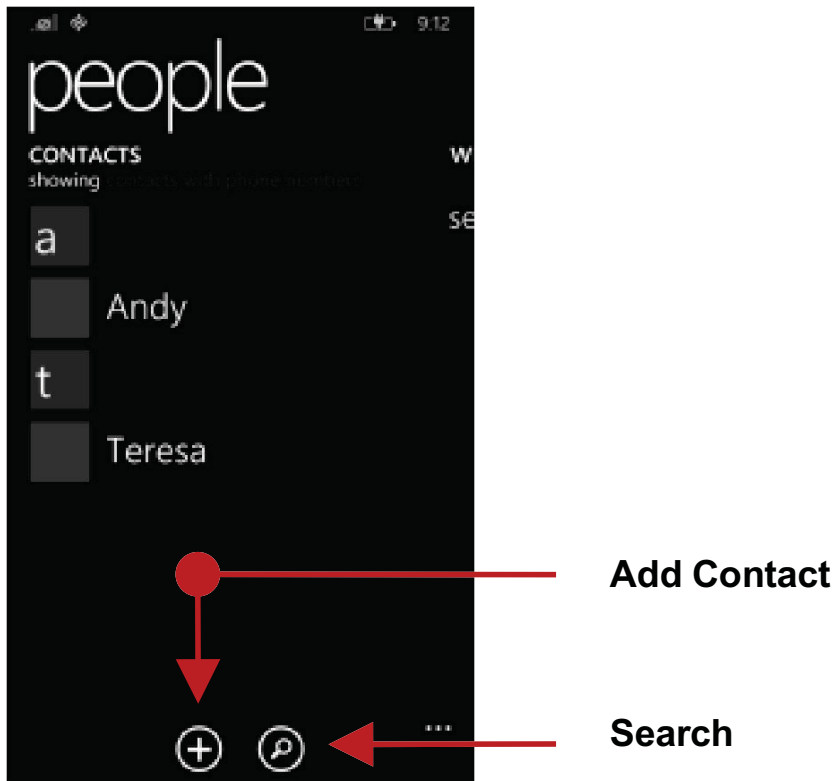

Click the Search icon to enter the contact search interface.

- Any numbers or letters associated with any of the contacts saved in the list will be shown in the search results.

## Add New Contact

---

- Click the add contact icon (+) to add contact.
- You may enter different contact details which include adding a picture, name, telephone number, group, address, and email among other options.

Edit contact detail

Communicate with a contact

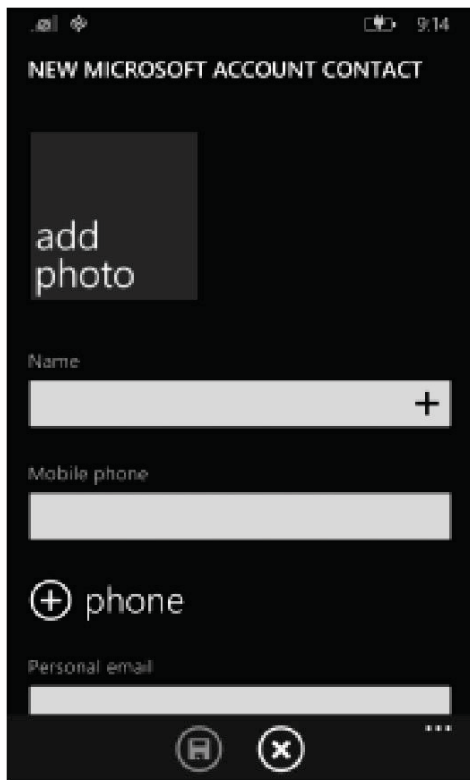

Contact name  
Can be added

**Note: Saving your contacts to your Outlook account facilitates both storage and synchronization with multiple entries across different handsets and tablets. When syncing your Outlook with a new phone, all your stored Outlook contacts are automatically synced with the new phone.**

## **Delete Contact**

---

- Click on the Contacts icon to enter the phonebook.
- Long press the contact you wish to delete.
- Click delete to eliminate contact from phonebook.

## **Import Contacts**

---

The phone allows you to import contacts to synchronize information between different storage types that include the SIM card, Outlook account and your phone.

### **To synchronize and import contacts:**

1. Press the Contacts icon to enter the phonebook.
2. Press the menu key and select setup an account or select import contacts from SIM.
3. Select the source account you want to import the contacts from. Once selected follow the instructions to sign into the account, to add the account to your phone and import the accounts contacts.
4. You can also import contacts from the SD card by following a few steps as followed.
  - I: make sure you have inserted the SD card into the right slot, and then connect your handset with PC.
  - II: access your SD card through PC, and create a folder named “/backup/Data/Contact”.
  - III: login your third party contact book like “QQ contact” through PC, import your contacts to local. Follow the instructions to copy your contacts into the director you created before. Then rename it as “contact.vcf”.
  - VI: unlock your handset, follow the “3rd” step to import your contact from the SD resource.

# Messaging

You may use this function to exchange text messages and multimedia messages with your family and friends. The messages to and from the same contact or phone number will be saved into a single conversation so you may see the entire message history conveniently.

After you clicked the message app, you will see the message log panel and you can access message settings by click the menu which is at the bottom of the panel.

## **Send an SMS**

---

Click on the Messaging icon

- Click the (+) add recipient icon to enter text message recipient
- Compose Text Message and click to send.

## **Delete an SMS**

- Click the select icon to enter message selecting panel.
- Select the icon on the left to mark the messages that you want to delete just as shown in screen shot.





Select icon,  
enter into  
delete penal

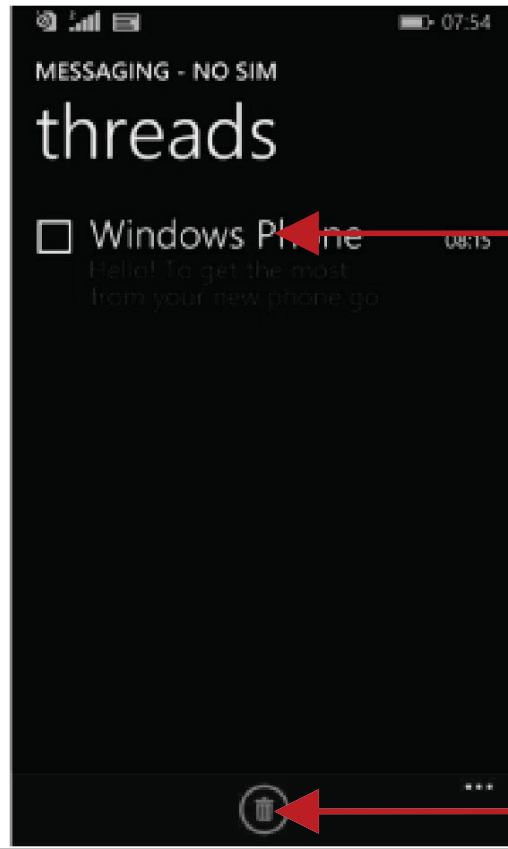

Click this icon  
to mark the  
message

Delete icon.

## Send an MMS

---

When creating message, the default message style is SMS.

- Click the attachment icon in the messaging interface.
- Click to add attachments (photos, videos, capture picture, capture videos, voice note, record audio, contact, my location) and create an MMS message. Just as the following pictures showed. All you need to do is click the attachment icon.

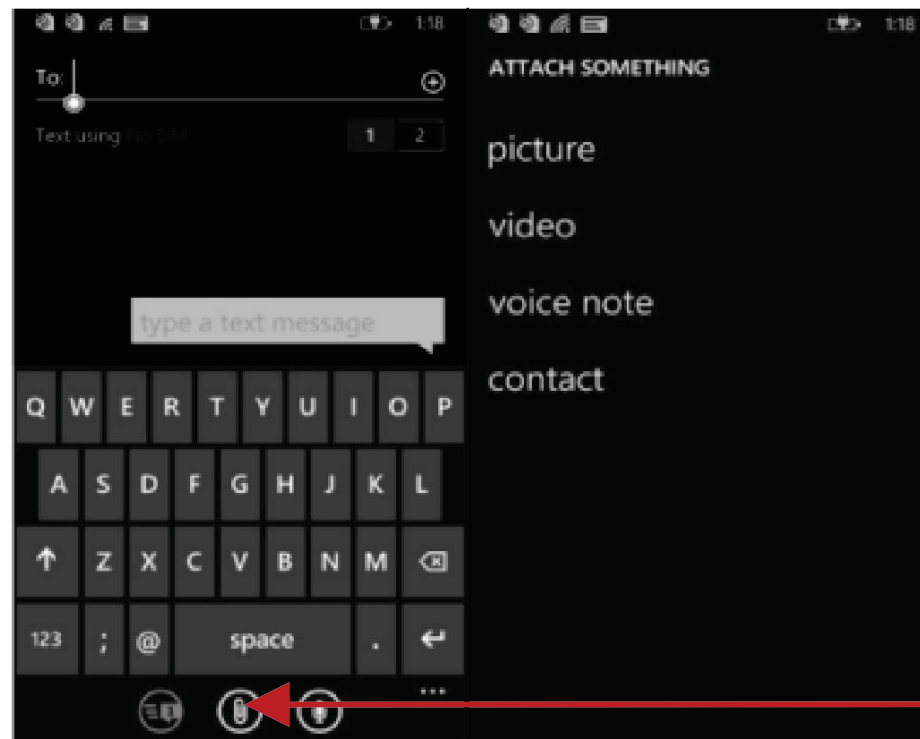

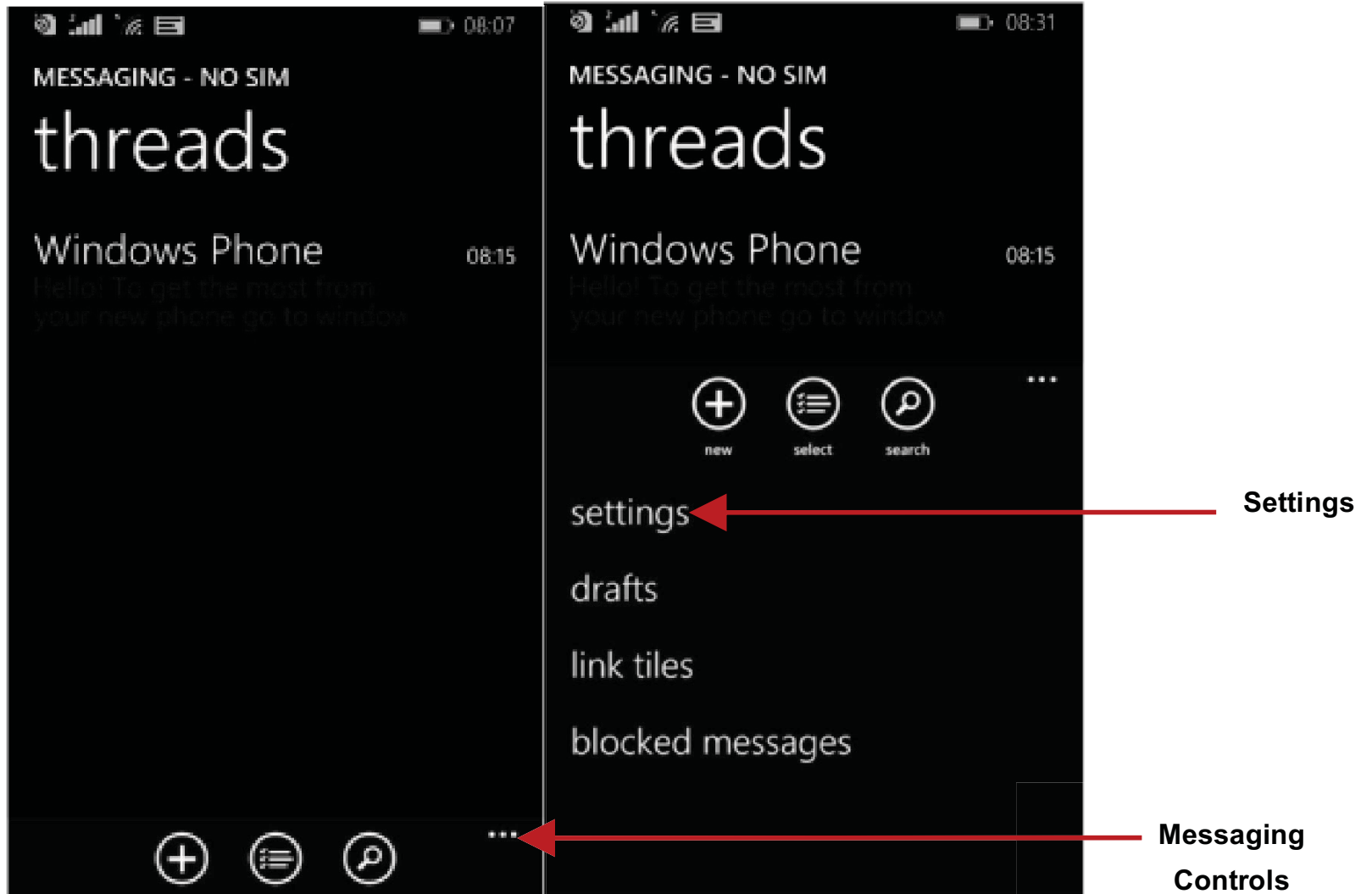

The above two pictures showed how to access message settings. Just click the menu.

# Connectivity

Bluetooth is a short-range wireless communications technology that devices can use to exchange information and connect to different types of devices which include headsets and other devices.

## Power on Bluetooth

---

Settings » Bluetooth and select to power on Bluetooth.

- The Bluetooth icon will appear in the notification bar. The Bluetooth will then start to scan for all devices within its range and will display all available devices in a list.



**List of available Bluetooth devices**

**Note: The maximum detecting time of the phone is 2 minutes.**

## Power on Wi-Fi

Settings » Wi-Fi and select ON to power on Wi-Fi

- Go to Menu> System settings> wireless & networks and then tap Wi-Fi.
- Next, go to **Menu> settings> wireless & networks>Wi-Fi Settings** and then enable Wi-Fi. Next, select the WIFI connection listed under Wi-Fi networks.

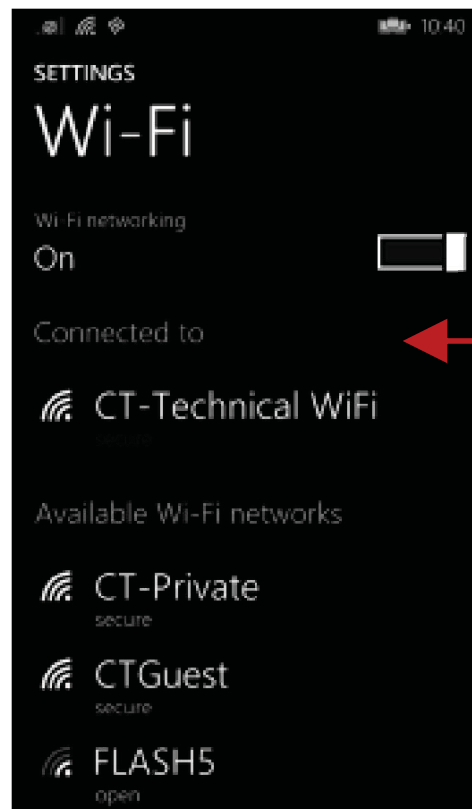

**List of available  
networks and the  
network connection  
screen**

## **Connect PC to transfer files from handset**

---

When you try to transfer your files(for instance photos, audios, videos) from your handsets, all you need to do is following the steps:

- Connect your handsets with PC through the USB cable. Then the PC will find your device automatically. And pop-up a dialog box automatically.
- Click the dialog box enter into the director of your handsets. Or you can Open “MyComputer ” on your PC screen, you can see an add disk which is your device.

**Note:** Please be well noted that different files are stored in different directions.

# **Internet Explorer**

## **Menu Functions**

---

### Favorites

This option displays favorites

### Add to favorites

This option will add to favorites

### Find on Page

This menu option finds texts on the page.

### Share Page

This menu option shares the webpage

### Pin to Start

This menu option pins to start

### Recent

This menu option displays recent webpage activity.

### Settings

This menu option displays internet explorer settings

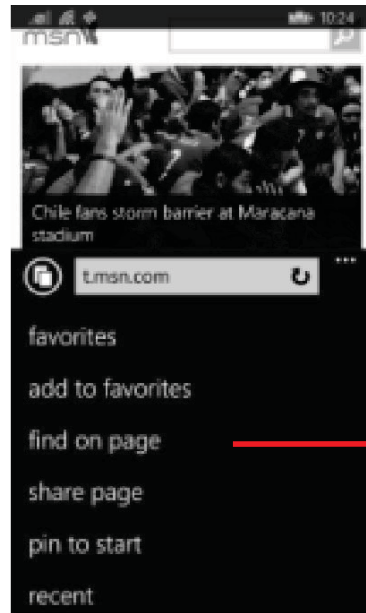
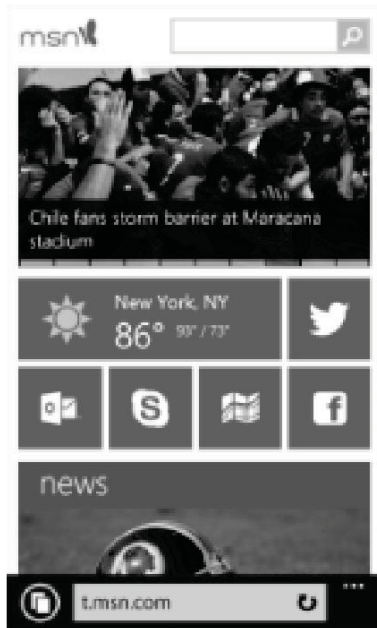

**Click menu to  
access the internet  
browser options.**

## Outlook

Outlook is Microsoft's free email service. To access the Outlook program, click the applications menu and click on the Outlook icon and either sign in with your existing account or create a new one.

**Note:** In order to keep accounts streamlined with Microsoft services, your Outlook account user name and password may be used for some Microsoft programs.



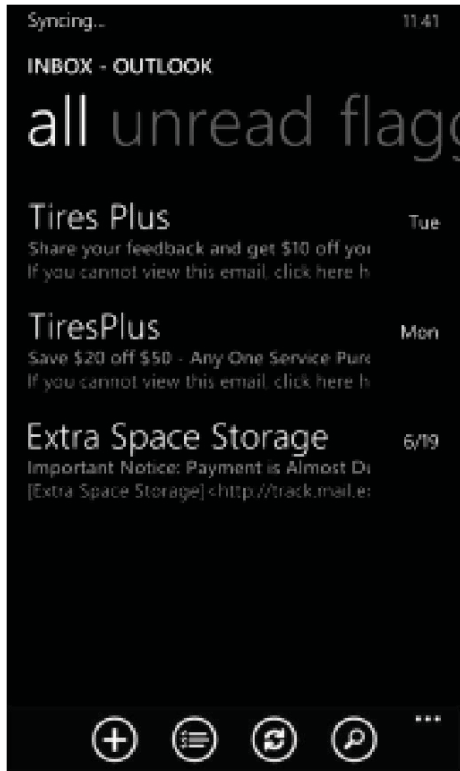

**The Outlook inbox is separated in different categories**

**Scroll Outlook to view different categories.**

## Store

Windows Store allows you to download programs and games directly to your device. To access the Store, click on the Store icon and search the specific category.

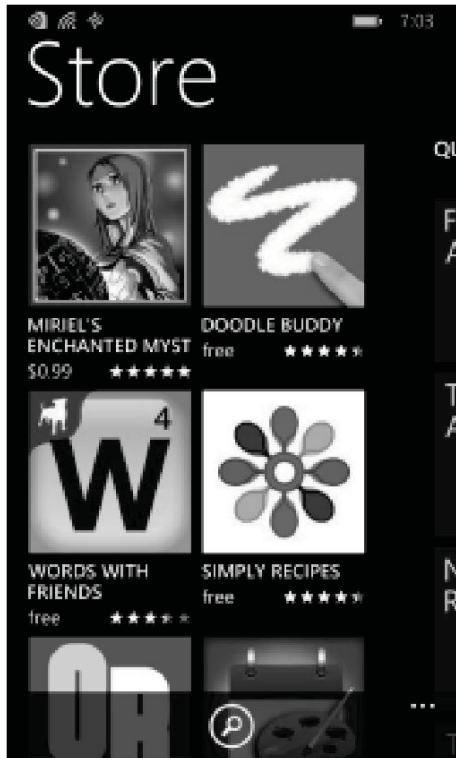

Search and select between different Store categories

## Camera

**Prior to use:** Insert SD card before using the camera or video camera. All photos or videos taken by the phone should be stored in the memory card for large storage capacity of images and videos.

Click the Applications Menu » Camera

→ Switch to video mode if you want to record videos.

## Take Pictures

Aim at the object that the picture will be taken.

- Press the Shutter button on the screen to capture image.
- After taking the picture, the file will be saved in the default save location.

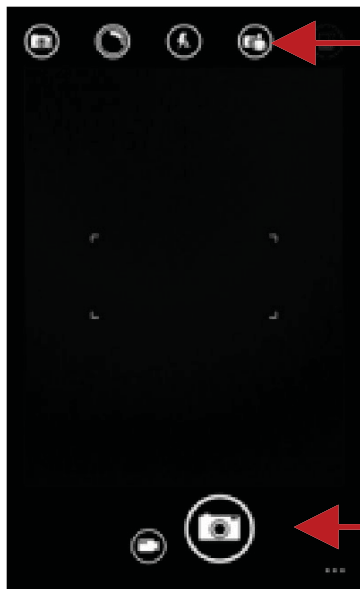

Camera Modes

Select between  
Camera & Video

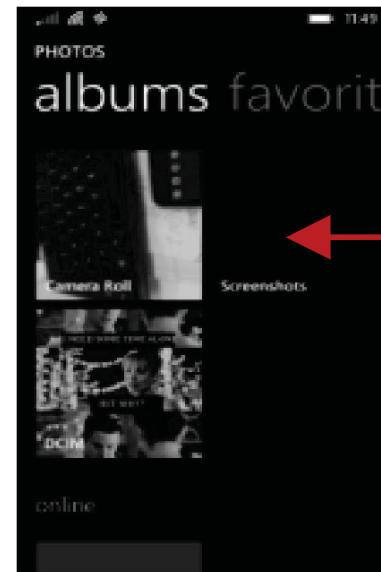

Pictures are stored  
in different album

## Photos

Click on the Photos icon

## Share & send image

---

You may share pictures by sending them through different types of installed applications. You may also send pictures through the MMS message function by attaching a picture and also via Bluetooth.

- Open the album and select the images or open an image, press menu and select share.
- Press the share button, the menu of share & send ways will pop up.

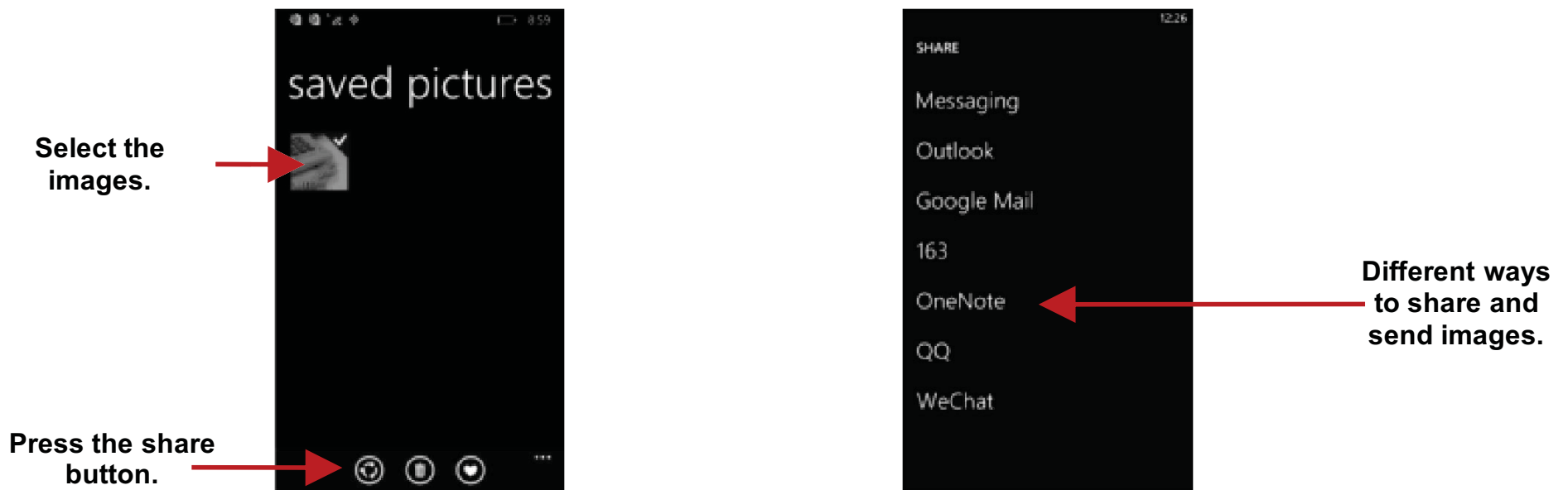

# Music

## Open Music

Application Menu » Music

## Search Music

You may choose to search for music from media folder through artist name, song name, album name among other options.



# FM Radio

## FM Radio

---

Through this function, you may listen to FM radio on the device.

**NOTE:**The FM radio uses the wired headphones as an antenna in order to receive signal. Before using this function, connect the original equipment headphones that came with the phone.

## Open FM radio

---

Press the FM Radio icon to open the application.

Click to scan FM channels automatically then click to add any of your favorite radio stations.

## Turn on/Off FM radio

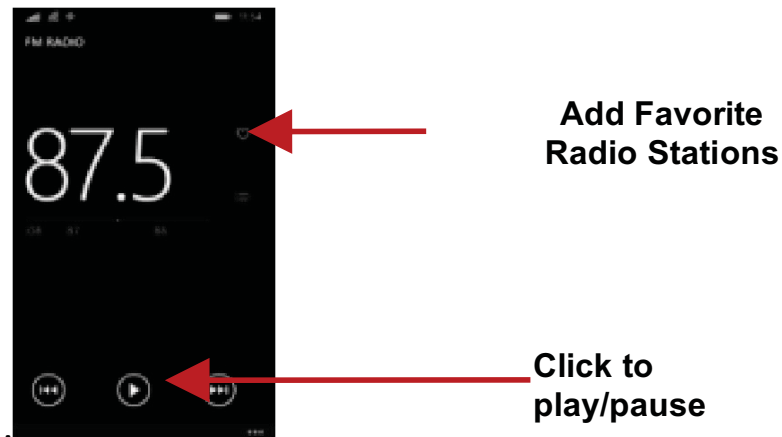

## FM Radio as Background

Click on the Start key to move the FM Radio to the background.

## Calendar

The calendar helps keep track of your life's most important moments in one application.

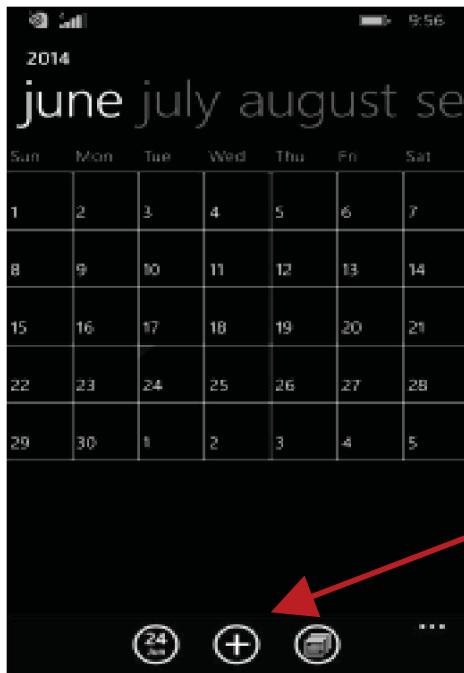

Click the (+) button to enter a new event

Click the calendar button to change views

# Alarm Clock

In settings, click on Alarm to enter the alarm clock settings

This option allows you to add and edit alarms.

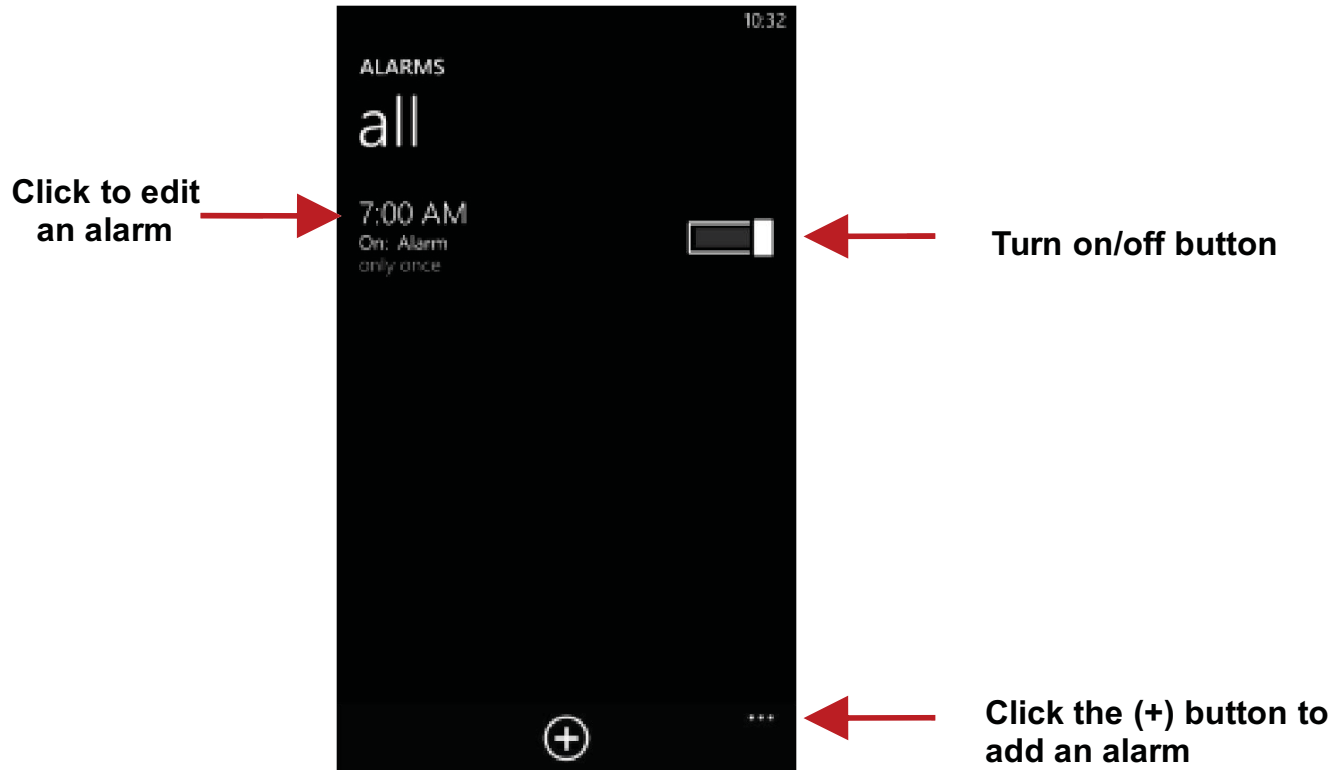



Click to select  
ringtone or  
vibrate

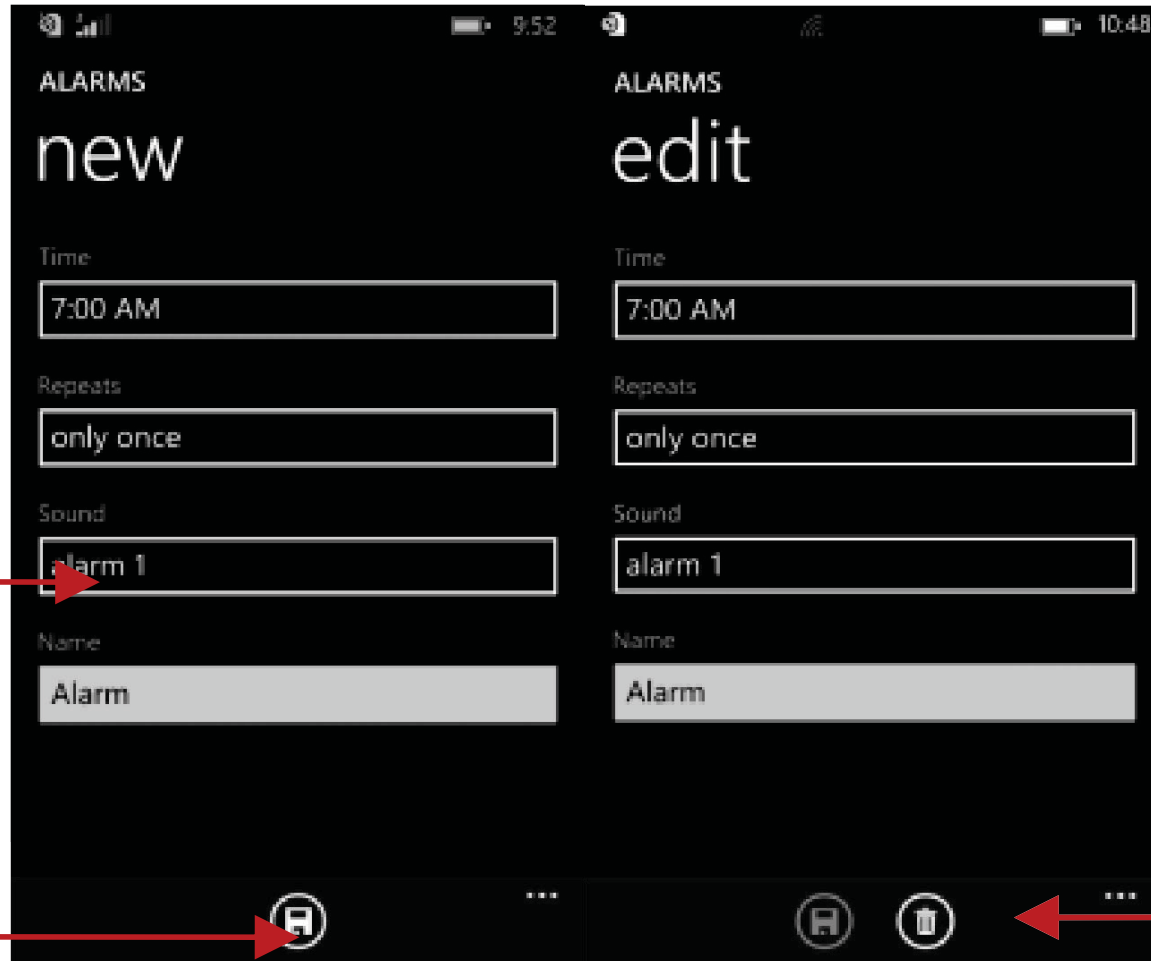

Click to save  
settings

Click to delete an  
alarm

# Data Sense

The data sense shows the cellular and WLAN usage and helps to find more efficient ways to use cellular data.

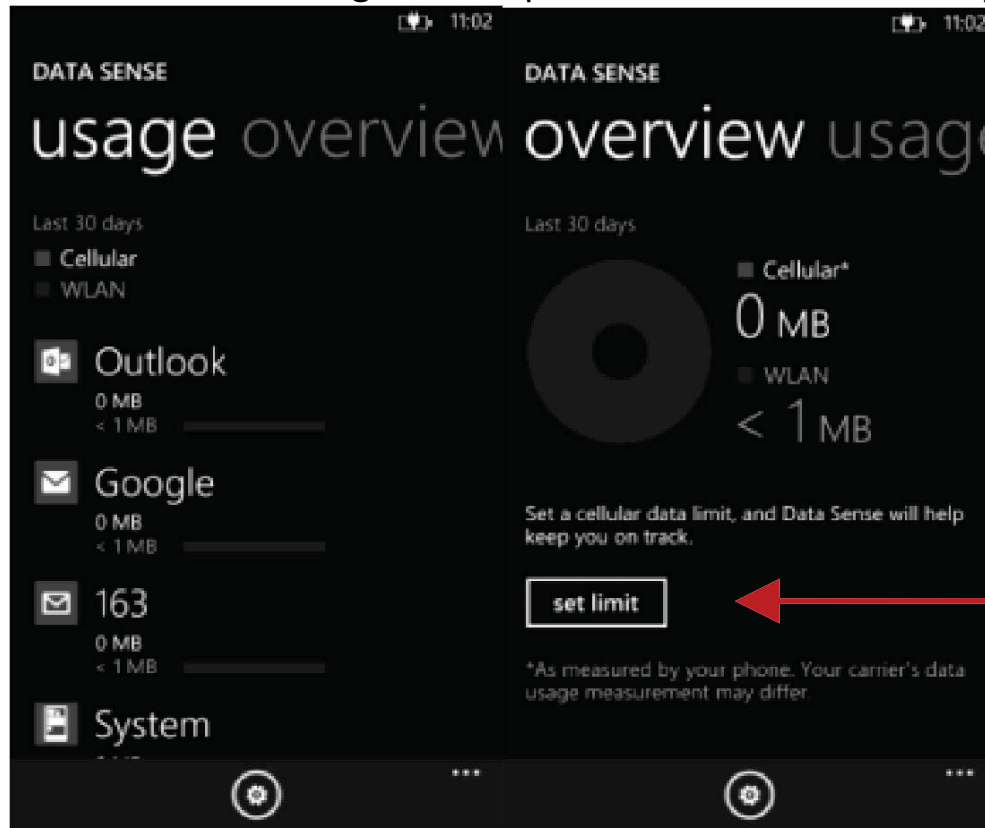

**Set cellular data limit to conserve the usage**

# Storage Sense

Connect the phone with the USB cable provided. Once connected, a connection interface will appear. In the connection mode interface, select one of the available options to transfer files to your computer.



**You may select to transfer files through USB connection.**

# Troubleshooting

Below is a list of common problems that may occur when using your mobile phone. Try these easy troubleshooting steps to resolve any type of issues you may encounter.

## **The phone does not power on**

- Press and hold the power key until the startup sequence appears on the display.
- Check the battery level and ensure there is sufficient charge.

## **The phone does not respond after several minutes**

- Remove and insert the battery – If the phone has an internal battery, please press and hold the power button.

## **The phone powers off by itself**

- Check if the screen lock of the phone is enabled.
- Check if the phone needs to be charged.

## **The battery won't charge**

- Check if the battery is already fully charged.
- Make sure that the battery is inserted correctly.
- Ensure that the battery being used is LAVA approved battery.
- Double check if the charger connector is properly connected to the phone and the socket

**Note:** Connect charger only after the battery has been inserted.

### **The standby time is too short**

- Please keep in mind that standby time relates directly to phone usage (Internet, Text, Voice Calls, Maps, etc.).
- Batteries typically have to be replaced after a year of use.

### **The phone cannot connect to the network (Voice or Data)**

- Verify if you have active service with your service provider.
- Contact your local network service provider and verify if you are within its network coverage area.

### **The phone display a SIM Error**

- Make sure the SIM is properly inserted and in its intended slot.
- Make sure that the SIM card is not damaged or scratched.

### **The PIN code was entered incorrectly three times**

- The SIM card will lock and you will need to enter the PUK code (PIN Unlock Code). Please contact your local service provider to obtain the PUK.

### **I cannot make calls**

- Make sure that the number you dialed is correct and the dial key has been pressed.
- Use the full national area code when dialing out of your area or when abroad, use country-specific international access codes.

### **I cannot receive calls**

- Make sure that your phone is connected to a network.
- Check the phones Call Divert and Call barring settings (Check with your service provider for these settings and codes)

#### **The caller ID does not display on incoming calls**

- Contact your local network service provider and verify you have the caller ID feature enabled on your account or verify if the caller may have blocked his number from appearing.

#### **The caller cannot leave a voicemail message**

- Contact your local network service provider and verify if the voicemail service is active on your account or check if the network is busy.

#### **The phone does not connect to the internet**

- Ensure with your service provider that your account has the appropriate internet/data plan enabled.
- Ensure internet APN settings are configured (Carrier dependent).

#### **Text Messages cannot be Sent / Received**

- Ensure text messaging is enabled with your service provider.
- Ensure text APN settings are configured (Carrier dependent).

# Safety Information and Notices

## Certification Information (RoHS)

We at LAVA take our social responsibility seriously and are committed to the cause of saving our environment, it is in keeping with these commitments that we are proud to state that LAVA phones are RoHS compliant.

## Certification Information (SAR)

Your phone is designed not to exceed the limits of emission of radio waves recommended by international guidelines. These guidelines include safety margins designed to assure the protection of all persons, regardless of age and health. SAR (Specific absorption rate) is the unit of body-absorbed RF quantity when the phone is in use. SAR value is ascertained according to the highest RF level generated during laboratory tests. The true SAR level during phone usage will be far lower than this level. The SAR value of the phone may change depending on factors such as how close you are to a network tower, use of accessories and other enhancements. The highest SAR value of the device is less than 1.6W/Kg averaged over 10 gm of human tissue. The SAR value may differ depending on national reporting, testing requirements and the network band. SAR Recommendations

Use a wireless hands-free system (headphone, headset) with a low power Bluetooth emitter. Please keep your calls short and use SMS whenever more convenient. This advice applies especially to children, adolescents and pregnant women.

Prefer to use your cell phone when the signal quality is good. People having active medical implants should preferably keep the cell phone at least 15 cm away from the implant. Maintain a preferable distance of 15 mm from the device.

## Using the Cell Phone and Charger

### Danger:

Only use the battery and charger approved by the manufacturer. Using other brands may cause battery leakage, overheating, explosion or even fire.

### Caution:

Keep the phone away from dust, water and damp areas. Dust, water or other liquids may cause overheating, electrical leakage, and/or phone failure.

The phone, battery, charger and AC adapter are not waterproof. Keep them away from liquid.

### Warning:

Do not bump, shake or tamper with the phone or charger. This may cause battery leakage, overheating, explosion or even fire.

Do not place the battery, phone or charger near a microwave or high-voltage device. This may cause battery leakage, overheating, explosion or even fire; also prevent the phone and AC adapter from overheating, smoking or short circuiting.

Do not use the phone around volatile oil. This may cause fire or damage.

To avoid any damage, do not disassemble the phone, battery, charger or internal components by yourself.



## Using the Cell Phone

### Warning:

Do not use the phone while you are driving. Pull over and stop your automobile to dial or listen to a phone call.

Usage of cell phones in aircrafts or in hospitals is prohibited. Switch the phone off to prevent interference with electronic medical devices. Follow any rules or regulations in such places.

Do not use the phone at a gas station, near fuel or near chemicals.

Do not use the phone near electronic medical devices such as hearing aids, pacemakers and auto-control devices such as fire detectors and automatic doors.

If you have to use your cell phone near an electronic medical device such as a pacemaker, please contact your manufacturer or dealer for information about preventing interference.

### Caution:

Electronic systems in automobiles such as anti-lock brakes, speed control, or fuel spraying systems, are usually not influenced by wireless devices. Manufacturers of these systems will tell you whether they are provided with good screening functions. If you suspect that an automobile failure is caused by a wireless wave, please contact your automobile dealer.

Avoid using your phone in crowded places.

Do not store your mobile phone near, or together with, a credit card, disk or other magnetic materials. This may effect information stored on your phone.

Keep your phone away from pins. Pins can be absorbed by the phone's receiver magnet, which may cause harm.

## Using the Battery

### Danger:

Do not dispose of the battery into a fire. Doing so may cause battery explosion or even fire.

If you have difficulties installing the battery, do not force the installation. This may cause battery leakage, overheating, explosion or even fire.

Keep metal objects away so they don't come in contact with the battery or its connectors as it may cause the battery to short circuit, overheat or explode.

Do not weld the polarities of the battery directly together. This may cause battery leakage, overheating, explosion or even fire.

Battery liquid is severely harmful for your eyes. If battery liquid gets in your eyes, do not rub them. Instead, wash your eyes with water first and then go directly to a doctor for help.

Do not use or store your phone in high temperature areas. This may cause battery leakage, overheating, explosion or even fire.

### Warning:

If battery liquid leaks onto your skin or clothes, immediately wash the affected parts with water.

If the battery begins to leak or emits a strange odor, properly dispose of the battery according to local regulations. Do not throw it into a fire.

### Caution:

Do not leave the product or its battery inside a vehicle or in places where the temperature may exceed 60°C (140°F), such as on a car dashboard, window sill, or behind a glass that is exposed to direct sunlight or strong ultraviolet light for extended periods of time. This may damage the product, overheat the battery, or pose a risk to the vehicle.

## Using the Charger

### Danger:

Only use the charger that came with the phone. Using a different charger may cause the phone to break or an explosion.

If the charger short circuits or breaks, a fire may occur.

Do not use a damaged, worn or broken charger. This may cause a fire.

Clean dust away from the power socket to avoid the possibility of a fire.

Do not store the charger near any liquids. If liquids spill onto the charger it may cause it to overheat or break,

If liquid does spill onto the charger, immediately unplug the power cable to prevent overheating, fire or another type of break.

Do not use the charger in places with high humidity like a bathroom. This may cause a fire.

Do not touch the charger, power cable or socket with wet hands. This may cause an electric shock.

### Caution:

Keep the environment temperatures within the range of 0°C ~40°C while charging. Temperature below 0°C or higher than 40°C will cause insufficient charging, terminate charging or even cause the battery to explode.

Unplug the charger from its power source before cleaning it.

Do not place heavy objects on the power cord. This may cause electric shock or fire.

Hold the plug while unplugging the power cord; this will avoid any potential damage or even fire.

### **Requirements for Cell Phone**

Avoid using your mobile phone in extremely high or low temperature. Use the phone in a temperature range from

-10~55°C and humidity of 35%~85%.

It is recommended that you do not use your mobile phone near a telephone, TV set, radio or other radio frequency sensitive devices.

### **Requirements for the Battery**

When not in use, store the battery in a cool, well-ventilated place with sunshine.

If you won't be using the cell phone for an extended period of time, charge the battery on a regular basis to avoid battery breakdown.

### **Requirements for the Charger and AC Adapter**

Do not charge your phone under the following circumstances: sunshine, temperatures equal to or lower than 0°C, temperatures equal to or higher than 40°C, high humidity, dust, high vibration areas, or near a TV, a radio, etc.

## Cleaning and Maintenance

The mobile phone, the battery and the charger are not waterproof. Do not use them in places with high humidity like a bathroom and also avoid spilling any liquids on the phone, battery or charger.

Use a soft cloth to clean the mobile phone, the battery and the charger.

Do not use alcohol, diluted liquid or benzene to clean the mobile phone.

If dust gets in the sockets the phone can be damaged, short-circuit or even the lose the ability to be re-charged. Be sure to clean the socket regularly.

## Lava warranty certificate

### Limited warranty:

LAVA international Ltd. (LAVA) provides limited warranty for your mobile phone and original accessories delivered with your mobile phone (hereinafter referred to as “product”)

The warranty period for the transceiver is one (1) year and for battery, charger and headset is six (6) months from the date of purchase.

### LAVA Warranty:

Subject to the conditions of this Limited Warranty, LAVA warrants a product to be free from defects in design, material and workmanship at the time of its original purchase by you, and for a subsequent period of one (1) year

for transceiver and six (6) months for battery & charger.

You shall have no coverage or benefits under this warranty in the event that any of the following conditions are applicable:

- The product has been subjected to abnormal use or conditions, improper storage, exposure to .excessive moisture or dampness, exposure to excessive temperature, unauthorized modification, unauthorized repair (including but not limited to use of unauthorized spare parts in repairs), abuse, accidents, Acts of God, spills of food or liquids, improper installation
- You have not notified Lava of the defect in the product during the applicable warranty period.
- The product serial no. code or the accessories date code has been removed, defaced or altered.
- The product has been used with or connected to an accessory (i)Not supplied by Lava or its affiliates, (ii) Not fit for use with the product or (iii) Used otherwise than in manner intended.
- The seals of the product's battery enclosure have been broke nor shown evidence of tempering or the product's battery has been used in equipment other than that for which it. has been specified usable by LAVA.
- All plastic surfaces and all other externally exposed part that is scratched or damaged due to normal use.

**To get maximum of your new product, we recommend you to:**

- Read the guidelines for safe and efficient use as mentioned in the manual.
- Read the terms and conditions of your Lava warranty in the manual.
- Keep your original receipt; you will need it for warranty services if asked to produce.

- Present this Lava Warranty Certificate along with original proof of purchase whenever you require any warranty services.

In case Lava product needs service, please visit the nearest Lava service centers given in the service guide. Please visit our Website [www.lavamobiles.com](http://www.lavamobiles.com) for updated list of Authorized Service Centers near to your location.

Important note: for your warranty to be valid, all information on the warranty certificate has to be completed including the stamp from the authorized distributor/retailer.

All warranty information, product features and specifications are subject to change without notice.

IMEI No. ....

Dealers Stamp .....

Date of purchase .....

Model No. ....

Service Centre number: **1860-200-7500**